

Soils Map

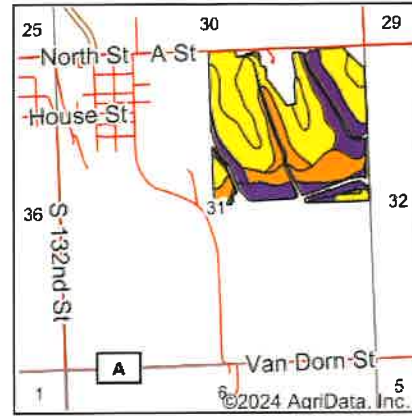
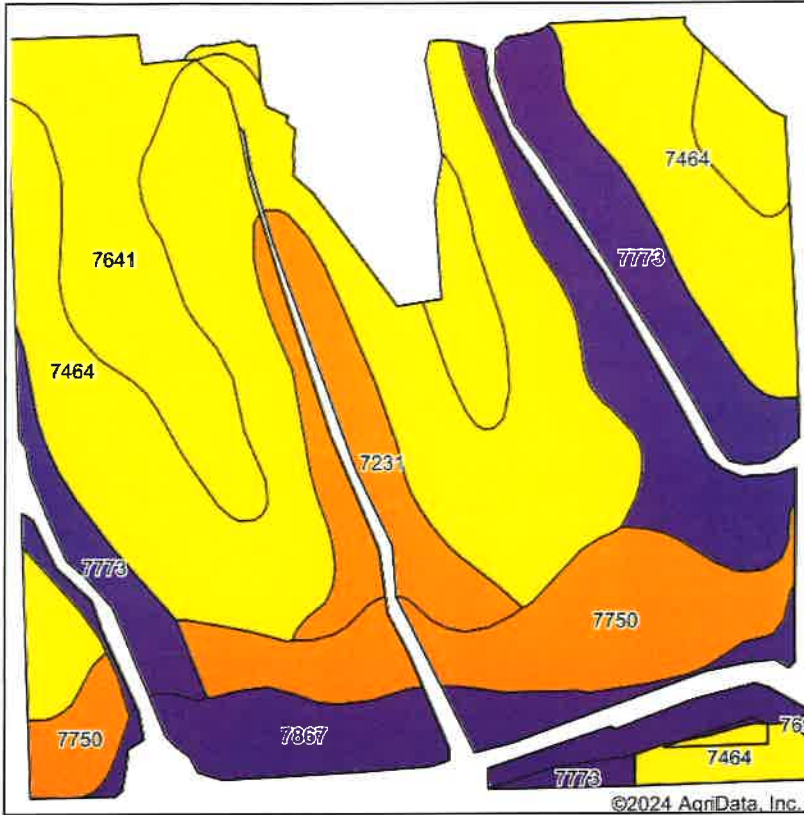

State: **Nebraska**
 County: **Cass**
 Location: **31-10N-12E**
 Township: **Avoca**
 Acres: **136.71**
 Date: **6/24/2024**

3E Easter & Associates
 Insurance - Real Estate - Auctioneering

Maps Provided By: **surety**
 CUSTOMIZED ONLINE MAPPING
 © AgriData, Inc. 2023 www.AgriDataInc.com



Soils data provided by USDA and NRCS.

Area Symbol: NE025, Soil Area Version: 23

Code	Soil Description	Acres	Percent of field	SRPG Legend	Non-Irr Class *c	Irr Class *c	Range Production (lbs/acre/yr)	SRPG	Alfalfa hay Tons	Corn Bu	Soybeans Bu	*n NCCPI Overall	*n NCCPI Corn	*n NCCPI Small Grains	*n NCCPI Soybeans
7464	Otoe silty clay loam, 6 to 11 percent slopes, eroded	58.19	42.5%	Yellow	Ive		3188	66				54	54	54	49
7773	Colo-Nodaway complex, frequently flooded	21.74	15.9%	Purple	Illw		1865	55	5	84	30	63	55	41	59
7641	Yutan silty clay loam, 2 to 6 percent slopes, eroded	19.65	14.4%	Yellow	Ile	Ille	3973	69	3	77	26	59	59	59	56
7750	Nodaway silt loam, occasionally flooded	16.64	12.2%	Orange	Ilw	Ilw	4160	74				93	93	70	91
7867	Nodaway silt loam, channeled, frequently flooded	11.11	8.1%	Purple	Vlw		2565	59		4	2	52	51	28	46
7231	Judson silt loam, 2 to 6 percent slopes	9.38	6.9%	Orange	Ile		4224	79				79	79	66	71

Soils data provided by USDA and NRCS.

TRACT 1



Code	Soil Description	Acres	Percent of field	SRPG Legend	Non-Irr Class *c	Irr Class *c	Range Production (lbs/acre/yr)	SRPG	Alfalfa hay Tons	Corn Bu	Soybeans Bu	*n NCCPI Overall	*n NCCPI Corn	*n NCCPI Small Grains	*n NCCPI Soybeans
Weighted Average					3.34	*-	3229.2	66	1.2	24.8	8.7	*n 62.4	*n 61.1	*n 53.3	*n 58

*n: The aggregation method is "Weighted Average using all components"

*c: Using Capabilities Class Dominant Condition Aggregation Method

*- Irr Class weighted average cannot be calculated on the current soils data due to missing data.